

Select TX Cuttable Light bar



Product Information

- Wide 160 degree lens to ensure excellent uniformity, even at shallow depths.
- CRI >80 allows much better colour rendition in signage and advertising cases
- Aluminium PCB for enhanced thermal dissipation and longer LED life
- 1 length that can be cut (83mm spacing) between each diode to fit any application
- Fast and easy installation with universal connectors at each end of the Light Bar and connector accessories
- 5 Year Warranty for peace of mind

Specification Summary

SKU	Type	Voltage DC (V)	Rated Luminous Flux (lm)	Beam Angle (°)	Colour Rendering Index CRI (Ra)	Correlated Colour Temperature CCT (K)	LEDLength (mm)	Nº. of	Control
93135341	GECLB2465-1160-2	24	1080	160	>80	6500	1162	14	Static

Data above subject to component tolerance of +/- 10%

Accessories

SKU	Type	Description
93135342	GECLB-CTK-0250-2	Connector Lead Kit 250mm
93135343	GECLB-CTK-1500-2	Connector Lead Kit 1500mm
93135344	GECLB-CTK-0100-2	Power Lead Kit 100mm

Technical Summary

Input voltage	24V DC
Beam Angle	160°
Colour Temperature	6500K
Lumens	1080lm
Power Consumption	10.8W
Efficacy	100lm/W
CRI	>Ra80
Lifetime @L70B50	50,000hrs
Operating Ambient Temperature	-25°C to +60°C
Storage Temperature	-25°C to +70°C
Environmental Protection	IP20
Warranty	5 years
Controls	Static

Product Dimensions

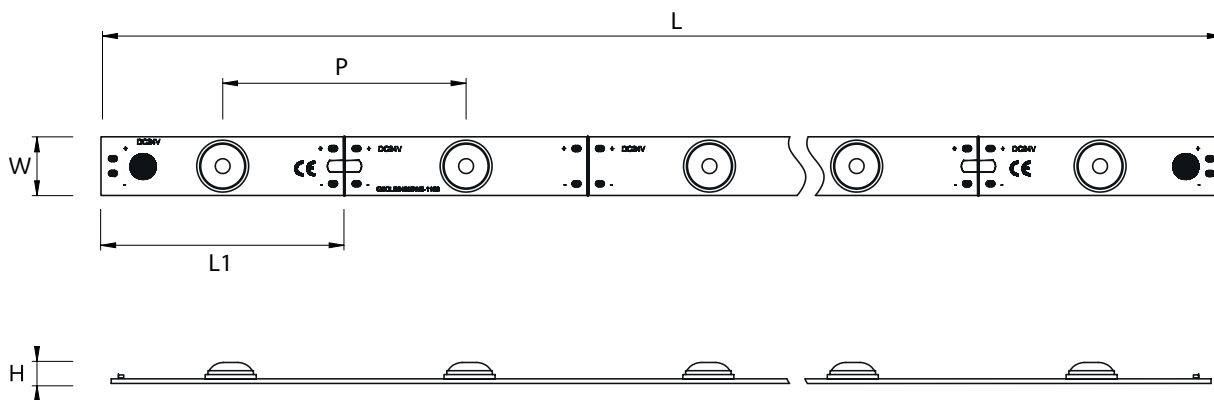

SKU	Length (L)	Width (W)	Height (D)	L1	P
GECLB2465-1160-2	1162mm	20mm	8.5mm	83mm	83mm

Product Images

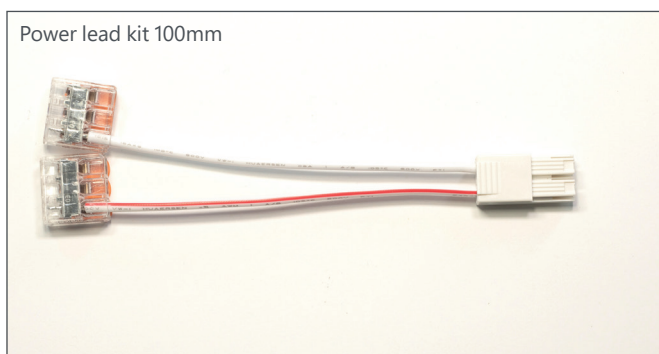
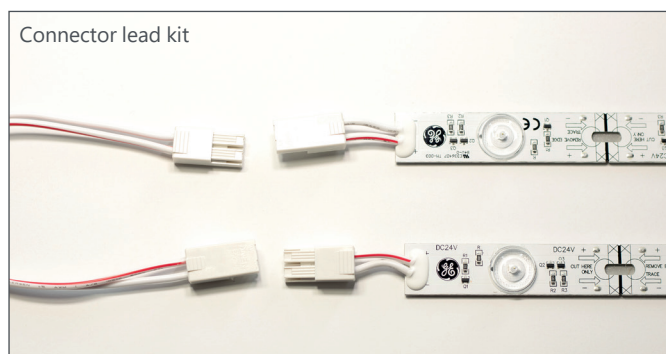
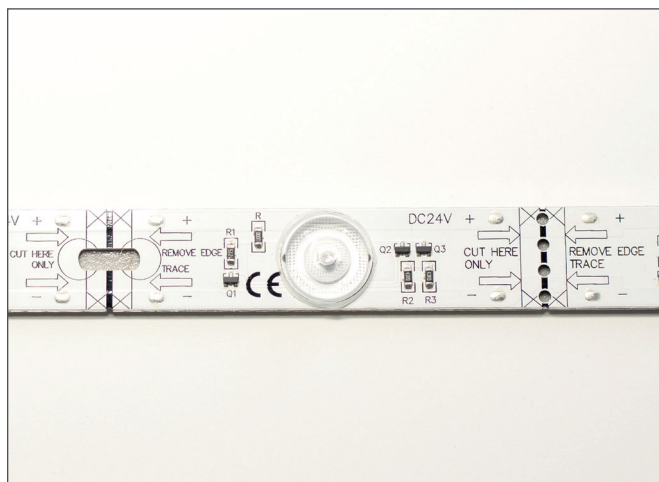

GE current
a Daintree company

www.gecurrent.com

GE Current, a Daintree company is constantly developing and improving its product. For this reason, all product descriptions in this sheet are intended as a general guide, and we may change specification to time in the interest of product development without prior notification or public announcement. All descriptions in this publication present only general particular of the goods to which they refer and shall not form part of any contract. Data in this guide has been obtained in controlled experimental conditions. However, GE Current, a Daintree company cannot accept any liability arising from the reliance on such data to the extent permitted by law.
Signage Cutable Light Bar Datasheet – Rev 27/08/2020 | SIGN291 EU